

# Hide-A-Luminous LED

## Specification

Input Voltage	10-30VDC
Input Current	1 Amps max
Output Power	1w-3w*4/6/8/9/12 (each single module)
Waterproof	IP67



Important



User Manual

## Recommend Operation Environment

Ambient Temperature: -30 to 85°C

Relative Humidity: 10 to 85% , non-condensing

## Caution:

Please ensure that you scan the QR code from above and read all important notices before proceeding with any installation or operation. Failure to thoroughly read these instructions may result in potentially serious consequences.

## Dimensions

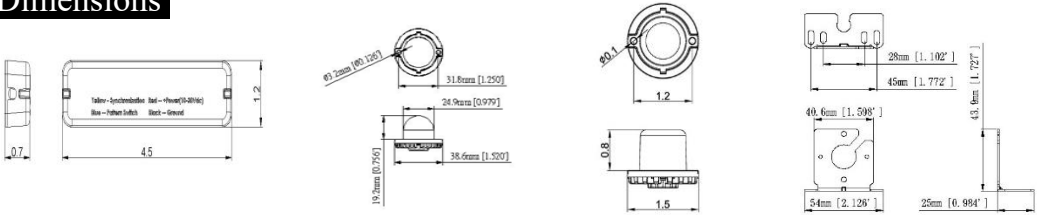

## L Bracket AND C Bracket (OPTIONAL ACCESSORY)

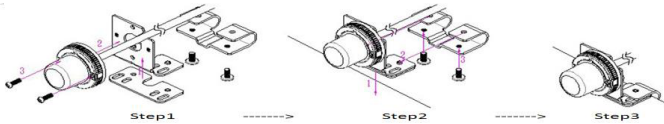

## Installation

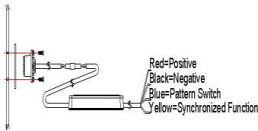

Standard Mount

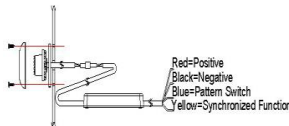

Flange Mount

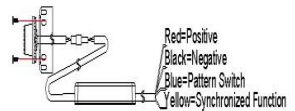

L Bracket Mount

A. Flasher Input Wire 270cm UL 4C Cable  
B. Flasher Output Wire 90cm UL 2C Cable

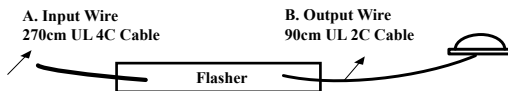

A. Input Wire  
270cm UL 4C Cable

B. Output Wire  
90cm UL 2C Cable

Flasher

# Flash Pattern

## For Single Color

PA NO.	Description
1	Single 75FPM Ph1 - Factory Default
2	Single 75FPM Ph2
3	Single 375FPM Ph1
4	Single 375FPM Ph2
5	Double 75FPM Ph1
6	Double 75FPM Ph2
7	Double 120FPM Ph1
8	Double 120FPM Ph2
9	Triple 75FPM Ph1
10	Triple 75FPM Ph2
11	Triple 120FPM Ph1
12	Triple 120FPM Ph2
13	Quad 75FPM Ph1
14	Quad 75FPM Ph2
15	Quad 120FPM Ph1
16	Quad 120FPM Ph2
17	Quint 150FPM Ph1
18	Quint 150FPM Ph2
19	ICAO CAP168
20	Steady burn

### Wire Function:

BLACK: Negative

RED:

- Single : apply to positive (Recommend add a 3A fuse)
- Dual : apply to positive for Mode 1

WHITE:

- Single : Stop/Turn/Brake/Tail Light Switch(Option)
- Dual : apply to positive for mode 2

BLUE: Pattern Switch

YELLOW: Synchronized Function

\*Maximum synchronized upto 8 units

### Operation:

**Apply BLUE wire TO NEGATIVE**

-Less than 1 sec. for next pattern

-between 1-3 sec. for previous pattern

-between 3-5 sec. for Factory Default(P1)

-more than 5 sec. for Steady burn-Color 1

### Phase Operation:

Phase Selection: Ph1= Phase 1 / Ph2=Phase 2

Phase 1 (Ph1) flashes simultaneously with Ph1

Phase 2 (Ph2) flashes simultaneously with Ph2

Ph1 alternates with Ph2

## For Dual Color

PA NO.	Description
1	Single 75FPM Ph1 Color1
2	Single 75FPM Ph2 Color1
3	Single 75FPM Ph1 Color2
4	Single 75FPM Ph2 Color2
5	Single 75FPM Ph1 Color1 Alt. Color2
6	Single 75FPM Ph1 Color2 Alt. Color1
7	Single 38FPM Ph1 (Color1) Alt. (Color2)
8	Single 38FPM Ph2 (Color1) Alt. (Color2)
9	Single 375FPM Ph1 Color1
10	Single 375FPM Ph2 Color1
11	Single 375FPM Ph1 Color2
12	Single 375FPM Ph2 Color2
13	Single 375FPM Ph1 Color1 Alt. Color2
14	Single 375FPM Ph1 Color2 Alt. Color1
15	Single 187FPM Ph1 (Color1) Alt. (Color2)
16	Single 187FPM Ph2 (Color1) Alt. (Color2)
17	Double 75FPM Ph1 Color1
18	Double 75FPM Ph2 Color1
19	Double 75FPM Ph1 Color2
20	Double 75FPM Ph2 Color2
21	Double 75FPM Ph1 Color1 Alt. Color2
22	Double 75FPM Ph1 Color2 Alt. Color1
23	Double 38FPM Ph1 (Color1) Alt. (Color2)
24	Double 38FPM Ph2 (Color1) Alt. (Color2)
25	Double 120FPM Ph1 Color1
26	Double 120FPM Ph2 Color1
27	Double 120FPM Ph1 Color2
28	Double 120FPM Ph2 Color2
29	Double 120FPM Ph1 Color1 Alt. Color2
30	Double 120FPM Ph1 Color2 Alt. Color1
31	Double 60FPM Ph1 (Color1) Alt. (Color2)
32	Double 60FPM Ph2 (Color1) Alt. (Color2)
33	Triple 75FPM Ph1 Color1
34	Triple 75FPM Ph2 Color1
35	Triple 75FPM Ph1 Color2
36	Triple 75FPM Ph2 Color2
37	Triple 75FPM Ph1 Color1 Alt. Color2
38	Triple 75FPM Ph1 Color2 Alt. Color1

PA NO.	Description
39	Triple 38FPM Ph1 (Color1) Alt. (Color2)
40	Triple 38FPM Ph2 (Color1) Alt. (Color2)
41	Triple 120FPM Ph1 Color1
42	Triple 120FPM Ph2 Color1
43	Triple 120FPM Ph1 Color2
44	Triple 120FPM Ph2 Color2
45	Triple 120FPM Ph1 Color1 Alt. Color2
46	Triple 120FPM Ph1 Color2 Alt. Color1
47	Triple 60FPM Ph1 (Color1) Alt. (Color2)
48	Triple 60FPM Ph2 (Color1) Alt. (Color2)
49	Quad 75FPM Ph1 Color1
50	Quad 75FPM Ph2 Color1
51	Quad 75FPM Ph1 Color2
52	Quad 75FPM Ph2 Color2
53	Quad 75FPM Ph1 Color1 Alt. Color2
54	Quad 75FPM Ph1 Color2 Alt. Color1
55	Quad 38FPM Ph1 (Color1) Alt. (Color2)
56	Quad 38FPM Ph2 (Color1) Alt. (Color2)
57	Quad 120FPM Ph1 Color1
58	Quad 120FPM Ph2 Color1
59	Quad 120FPM Ph1 Color2
60	Quad 120FPM Ph2 Color2
61	Quad 120FPM Ph1 Color1 Alt. Color2
62	Quad 120FPM Ph1 Color2 Alt. Color1
63	Quad 60FPM Ph1 (Color1) Alt. (Color2)
64	Quad 60FPM Ph2 (Color1) Alt. (Color2)
65	Quint 150FPM Ph1 Color1
66	Quint 150FPM Ph2 Color1
67	Quint 150FPM Ph1 Color2
68	Quint 150FPM Ph2 Color2
69	Quint 150FPM Ph1 Color1 Alt. Color2
70	Quint 150FPM Ph1 Color2 Alt. Color1
71	Quint 75FPM Ph1 (Color1) Alt. (Color2)
72	Quint 75FPM Ph2 (Color1) Alt. (Color2)
73	ICAO CAP168 Color1
74	ICAO CAP168 Color2
75	Modul Flash (Color1) Alt. (Color2)
76	Steady burn-Color 1
77	Steady burn-Color 2